

THIS DRAWING MAY BE USED ONLY FOR THE PURPOSE INTENDED AND ONLY WRITTEN DIMENSIONS SHALL BE USED

NOTES

1. Sign locations are indicative only and exact locations need to be determined on site

- NOTES**
- All traffic signs shall comply with Chapter 8 of the Traffic Signs Manual
 - Maximum distance between any two temporary traffic signals to be 240m. Minimum distance between any two temporary traffic signals to be 30m.
 - Temporary traffic signals shall not occur within 150m of an existing level crossing. Pelican crossing or signalised junction without the consent of the Engineer. The Engineer shall consult with the authority responsible for any of these types of facility prior to traffic management being installed in adjacent areas.
 - Coning shall be installed at 45° to the edge of carriageway.
 - Multi-phase portable traffic signals shall operate in vehicle actuated (VA) mode at all times unless otherwise directed by the Engineer.
 - Multi-phase portable traffic signals shall only be installed with the written permission of the local highway authority whose roads they are installed on.
 - Cable crossing protectors and P101SP13 signs shall be provided wherever control cables cross a section of carriageway open to traffic.
 - The signal control mechanism shall normally be placed in a location from which it is possible to view all approaches to the site.
 - Duplicate primary signal to be installed as instructed.
 - Lane width over the works to be 3.7m maximum, 3.25m desirable minimum, 3.0m absolute minimum.

KEY

- Cone
- Sign
- Safety zone to be used at work area 0.5m
- Traffic light head
- Traffic light phase
- Closed area

DETAIL B

- Single/Dual carriageway 40m or less - 400mm traffic cones, spacing 1.5m.
- Single/Dual carriageway 50m or more - 750mm traffic cones, spacing 1.5m.
- Dual carriageway national speed limit - 750mm traffic cones, spacing 1.5m, maximum 2m.

- Notes:**
- During darkness, warning lights to BS EN 12352:2009 should be provided in accordance with Table A1.3 (Appendix 1).
 - 24" dia. cones.
 - On motorways and M25, 30" dia. with hard shoulders, 1m cones will be required in both hard shoulder and motorway lanes for both top and the facing wall of lane changes.

DETAIL C1

- Single/Dual carriageway 40m or less - 400mm traffic cones.
- Single/Dual carriageway 50m or more - 750mm traffic cones.

- Notes:**
- During darkness, warning lights to BS EN 12352:2009 should be provided in accordance with Table A1.3 (Appendix 1).
 - For information to Detail C1 see Table A1.3 (Appendix 1).

Plant crossing added	AJSC	11/11/21	A
Revision Details	By	Date	Suffix
	Chk		

Drawing Number **25611.004**

Project Title **Truggist Lane**

Drawing Title **Temporary 3 way traffic lights with plant crossing**

Scale at A1: NTS	Drawn & Checked: A.JAGGERS	Approved By: T.ROBINS
Date: 01/11/21	Suitability: FOR CONSTRUCTION	



Vehicle Actuated phase timings			
Phase 1: STATION ROAD NB	Red	20s	
	Green	45s	
Phase 2: TRUGGIST LANE SB	Red	20s	
	Green	45s	
Phase 3: BERKSWELL STATION	Red	20s	
	Green	45s	

Please note: Timings may only be adjusted by a qualified operative to suit changing traffic conditions if required.

NOTE
Controller should be sited to provide clear visibility of the site when under manual control.

NOTE
Highway to be hardened to avoid carriageway breaking up under heavy vehicles crossing.
Further temporary works / construction design will be required.
Priority should be given to the public highway, not haul route as per Chapter 8 D3.23.1.
Highway to be kept clean at all times.

NOTE
Distance for advance signage as per 'traffic signs manual chapter 8 parts 1 & 2'.

NOTE
Vehicle washing area to be positioned on both sides of road.

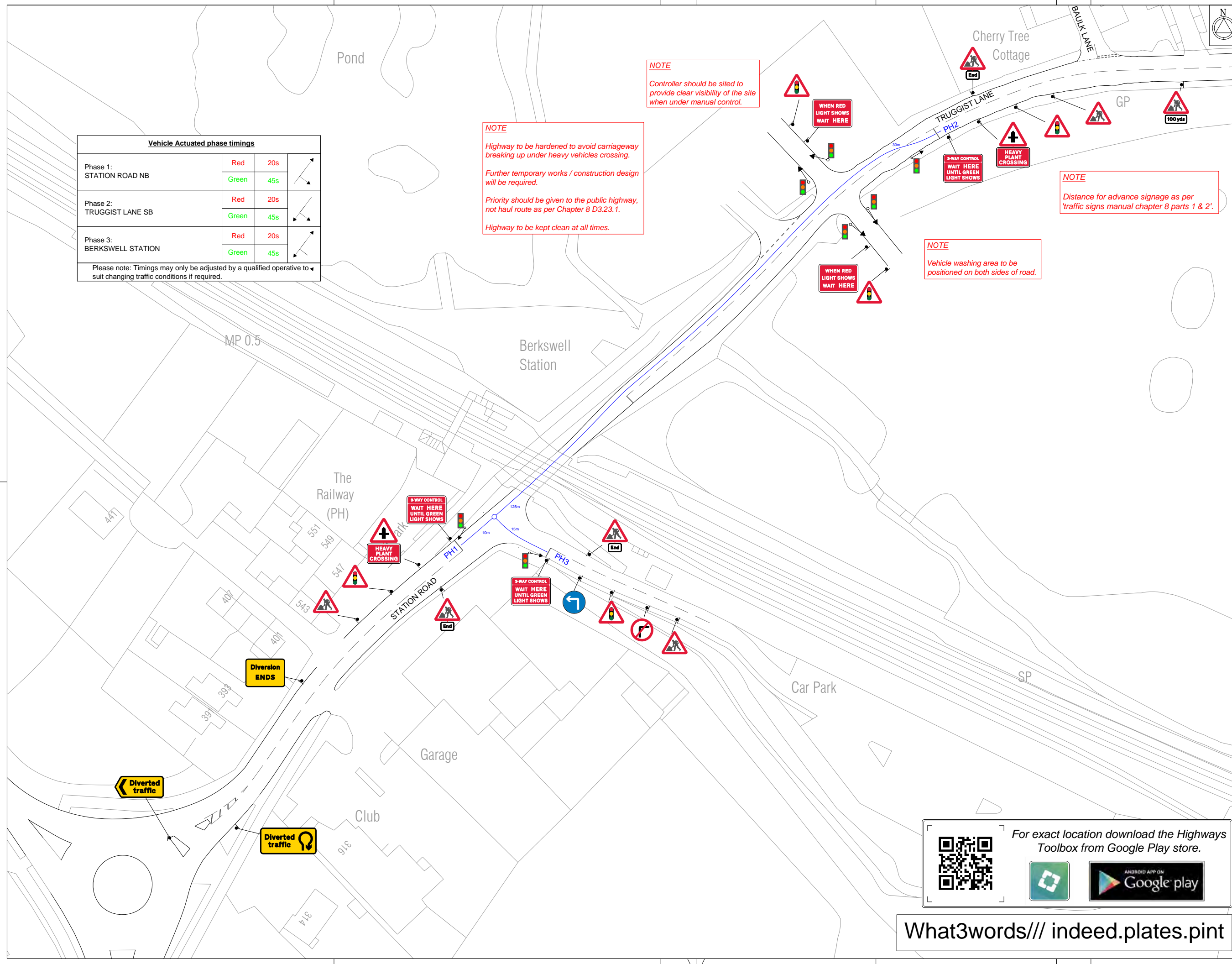

For exact location download the Highways Toolbox from Google Play store.

What3words/// indeed.plates.pint