

© Crown Copyright and the Ordnance Survey (OS) 2023. All rights reserved. This map is for informational purposes only and does not constitute a legal document. For more information, please contact the relevant authorities.

KEY

- Red Line Boundary
- Paved Footpath
- Highway

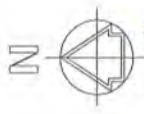

by J.S.

Plot 11/12/13/14/15/16/17/18/19/20/21/22/23/24/25/26/27/28/29/30/31/32/33/34/35/36/37/38/39/40/41/42/43/44/45/46/47/48/49/50/51/52/53/54/55/56/57/58/59/60/61/62/63/64/65/66/67/68/69/70/71/72/73/74/75/76/77/78/79/80/81/82/83/84/85/86/87/88/89/90/91/92/93/94/95/96/97/98/99/100

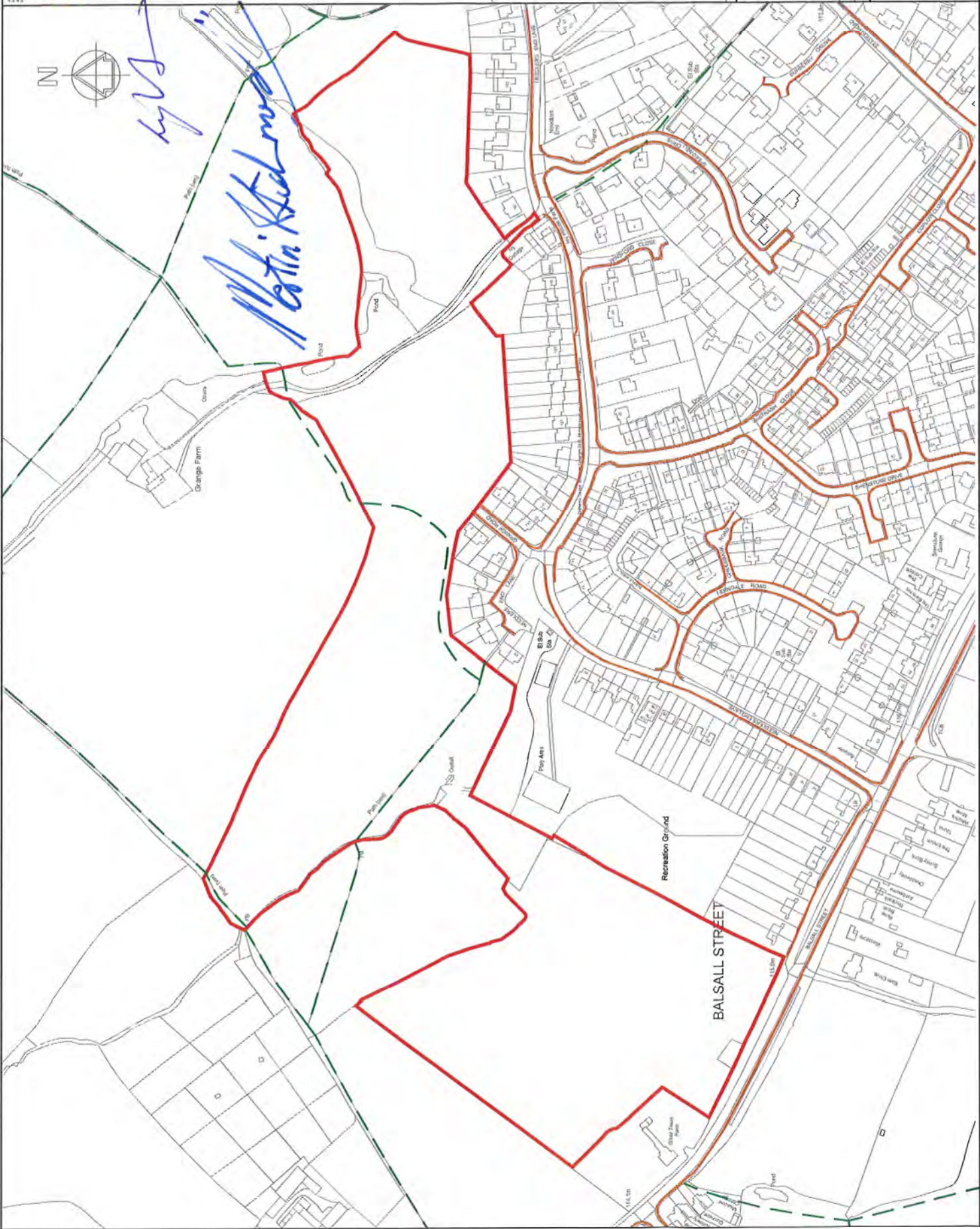

Public Footpath (over road)
Public Footpath (over road)

**Land at Balsall Street & Needlers Lane
Balsall Common**

Plan 1

DATE:	11/09/2021	BY:	J.S.
SCALE:	1:1000	PROJECT:	000001

L&Q Estates

04549 41000
 01925 333339
www.lqestates.co.uk